

Magerack Roof Attachments (Compatible with Most Manufacturers' Rails)

Catalog/Specification Sheet

Material: Aluminum alloy 6061-T6, aluminum 3003-H14, and 304 stainless steel
Finish: Clear and black anodized or mill finish
Warranty: 25-year limited warranty

L-foot with Flashing

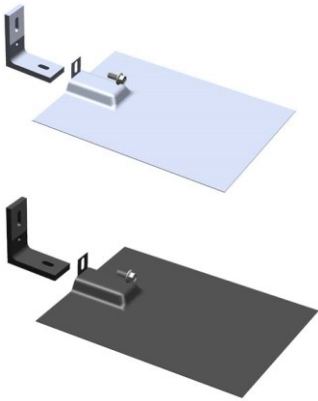

Part #	Description	Slot Height
101-019-101	L-foot with flashing (3.5" L-foot and flashing)	2.24" – 2.87" (56.9 – 72.9 mm)
101-019-102	Tall L-foot with flashing (4.5" Tall L-foot and flashing)	3.24" – 3.87" (82.3 – 98.3 mm)
101-019-201	Black L-foot with black flashing (3.5" Black L-foot and black flashing)	2.24" – 2.87" (56.9 – 72.9 mm)
101-019-202	Black Tall L-foot with black flashing (4.5" Black tall L-foot and black flashing)	3.24" – 3.87" (82.3 – 98.3 mm)

Tile Hook and Flashing

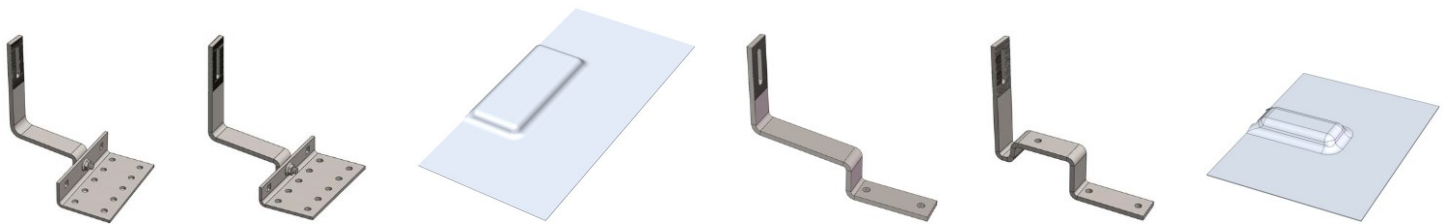

Part #	Description	Slot Height
101-019-110	Height-adjustable tile hook (tile hook top and bottom with carriage bolt and flange nut). Tile clearance: 1.25" – 2.13"	5.1" – 7.3" (129 – 186 mm)
101-019-111	Height-adjustable low tile hook (tile hook top and bottom with carriage bolt and flange nut). Tile clearance: 1.1" – 1.5"	4.2" – 6.0" (107 – 152 mm)
101-008-100	Flashing for tile hook and low tile hook (13"x7", fit 101-019-110 and 101-019-111)	
101-019-112	Flat tile hook. Tile clearance: 1.5"	4.4" – 5.9" (113 - 151 mm)
101-019-114	Stone-coated steel roof tile hook. Tile clearance: 2"	5.0" – 6.5" (128 - 166 mm)
101-008-300	Flashing for flat tile hook and stone-coated steel roof tile hook (9"x7", fit 101-019-112 and 101-019-114)	

Standoff

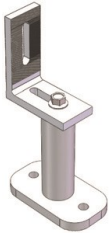

Part #	Description	Slot Height
101-019-104	4" Standoff with 3.5" L bracket	5.5" – 7" (139 - 177 mm)
101-019-106	6" Standoff with 3.5" L bracket	7.5" – 9" (190 - 228 mm)

Conduit Mounts

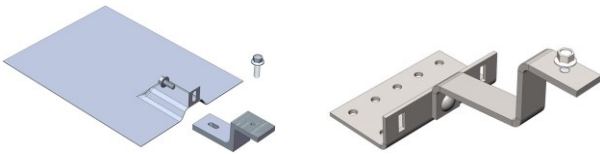

Part #	Description
201-122	Comp conduit mount with flashing for composition shingle roof
201-126	Height-adjustable tile conduit mount for tile roof

Accessory Bracket



Part #	Description
301-204	Accessory Mounting Bracket – Install microinverter, optimizer, etc. on the back of solar module